

The River Room



**EVENT DESTINATION
SPRING GREEN, WI**

Photography Credit-Copper Antler Photography
& S. Cole Photography

Banquets & Events

Thank you for considering Wisconsin Riverside Resort, located on the beautiful banks of the Wisconsin River, for your upcoming event. Wisconsin Riverside Resort will take pride ensuring you have a memorable experience and we are here to assist you in any way possible.

The River Room seats up to 400 guests with a stage, roomy dance floor, private bar and in-house catering. The River Room is the perfect venue for any occasion!

- ◇ Holiday Parties
- ◇ Fundraisers
- ◇ Company Events
- ◇ Meetings
- ◇ Luncheons
- ◇ Bridal & Baby Showers
- ◇ Reunions
- ◇ Graduation Parties

Planning your event at WRR couldn't be easier! Call today—dates book fast! We look forward to assisting you with your event.

Cheri Luther

Cheri Luther

Event Coordinator

608-588-2826

events@wiriverside.com

Revised 11.13.18

Information, Policies and Fees

ATTENDANCE, BILLING AND GUARANTEES

A signed contract and deposit is required to confirm your event with Wisconsin Riverside Resort. Wisconsin Riverside Resort will not hold any dates without deposit. All details and menus must be confirmed no later than 21 days prior to your event. Guaranteed number of guests is required 7 days prior to the event. The number of guests may not be decreased after this point.

DEPOSITS AND PAYMENTS

Deposit is due to confirm event. Full payment is due twenty-four (24) hours prior to your event by **cash or check**. An 18% Service Charge and 5.5% Sales Tax will be added to all totals. If desire to pay final bill with credit card a 2% fee will be added. Deposit will be applied to final bill. Any other charges incurred during the event must be paid at the end of your event before departure and can be paid by credit card or check. If your company is tax exempt, please provide a copy of your tax-exempt certificate prior to your event. Full payment for food is still required if your event is cancelled within 7 days prior to event.

ROOM RENTAL RATES

Room rates include setting up and breaking down for your event, round and rectangle tables, ivory table linens, video projector, microphone and PA System. Additional charge of \$250 for events that fall on a holiday. Minimum of 150 guests or \$2,500 food unless within 2 months. Please inquire to see if there are openings as smaller groups and reduced fees will be considered.

	<u>Sun-Thurs</u>	<u>Fri & Sat</u>
April 1 – October 31	\$350	\$1,500 (one half due at time of reservation)
November 1 – March 31	\$250	\$750 (one half due at time of reservation)

BEVERAGE SERVICE AND POLICIES

Wisconsin Riverside Resort reserves the right to determine the number of bartenders necessary to serve an event. Wisconsin Riverside Resort also reserves the right to refuse alcohol service to anyone under the age of 21 years or anyone who appears to be very intoxicated. All alcohol served will be dispensed by Wisconsin Riverside Resort Staff only. Special wines, champagnes, liquors and half barrels of beer will be available upon request at least 14 days in advance of event. Cash bar prices include sales tax. Sales tax and service charge will be added to pre-ordered bar items. You must pay for barrels of beer that you order. No refunds for unused barrels.

DINING

Wisconsin Riverside Resort would request that all parties be seated and dining no later than 6:30pm. Music must be finished by 12:30am as the banquet hall will close at 1am.

CAKES, FOOD AND BEVERAGE

All cakes need to be from a licensed baker. Please let us know in advance who will be providing the cake and time of delivery. Client is responsible for bringing their own cake plates, napkins and/or forks. All other food and beverage served or consumed on the premise must be purchased, served and prepared by Wisconsin Riverside Resort. Wisconsin Riverside Resort offers a variety of menu items, however, if you would like to custom design a menu for your group, please let us know. No leftover food or beverages may be taken from the premises. Please inquire about late night food service. Menu price list is subject to change at any time.

If you want something that is not listed, feel free to call us and we'll be happy to work with you.
Prices are subject to change. Prices do not include 18% service charge and 5.5% state sales tax.

Wisconsin Riverside Resort, 513220 Shifflet Rd, Spring Green WI 53588

608-588-2826 or events@wiriverside.com

Photography Credit-Copper Antler Photography & S. Cole Photography

Revised 11.13.18

DAMAGES AND CLEANING

The client is responsible for the conduct of their invitees and outside contractors. All damages which occur as a result of the client's guest and/or contractors will be paid by the client. Should damages be discovered after the completion of function, the client agrees to submit payment when an invoice is mailed to the address on file. Any damages and/or labor fees for excessive clean up or damage to property will be charged to the client. Wisconsin Riverside Resort has the right to charge a cleaning fee for excessive garbage, debris and mess done to the banquet facility and property.

NO FOG MACHINES OR PYROTECHNICS

Please notify your entertainment of this!

DECORATIONS

Any special requests or need to rent any items contact Event Coordinator. Please inquire for times to decorate, which depends on schedule of hall availability prior to event. Ladders will be available. Items not allowed include staples, nails, double sided tape (use only clear tapes). Any decorations deemed questionable as for their safety and/or cleanup can be refused by management. If you will be bringing special items such as: napkins, chair covers, etc., please let us know in advance.

LAYOUT

Rectangle and round tables will be available for your event. It will be up to the client and Event Coordinator to design the layout in advance. Event will include basic ivory linen table coverings and napkins. Wisconsin Riverside Resort reserves the right to reduce the size of the room with partitions based on group size.

CHAIR COVERS

Ivory Chair Covers are available for rent. \$2.50 per chair cover.

AUDIO/VISUAL EQUIPMENT

You are welcome to bring in needed audio/visual equipment. A PA system, sound system, projector and screen are available at Wisconsin Riverside Resort free of charge.

ENTERTAINMENT

If you plan to have entertainment at your event please let Event Coordinator know times, layout and any special requests.

UPLIGHTS

Uplights are available for rent for \$5 per light. Wide variety of colors and light patterns.

RISERS

Risers are available for rent for \$250. Please inquire about riser details.

CANCELLATION POLICY

If cancellation occurs after the signed contract is received and at least 6 months prior to the event date the client is entitled to ½ deposit refund. Wisconsin Riverside Resort reserves the right to keep the full deposit within 6 months of the event date. All cancellations must be received in writing. Cancellations due to acts of God rendering the client unable to meet its obligation shall not be subject to the cancellation fee.

If you want something that is not listed, feel free to call us and we'll be happy to work with you.
Prices are subject to change. Prices do not include 18% service charge and 5.5% state sales tax.
Wisconsin Riverside Resort, 513220 Shifflet Rd, Spring Green WI 53588
608-588-2826 or events@wiriverside.com
Photography Credit-Copper Antler Photography & S. Cole Photography

Revised 11.13.18

HOLD HARMLESS

Wisconsin Riverside Resort is not responsible for the loss of, or damage to articles left prior to, during or after the event. The resort is not responsible for any personal property, and client agrees to hold harmless if lost or damaged. Guests shall indemnify and hold Wisconsin Riverside Resort and its employees and affiliates harmless from any and all claims, suits, losses, damages, and expenses on account of injury to any party in connection with the function or resulting from damage or destruction of any Wisconsin Riverside Resort property by guests and any attendee of the function on the premises.

--A Quick Glance--



--The River Room--

If you want something that is not listed, feel free to call us and we'll be happy to work with you.
Prices are subject to change. Prices do not include 18% service charge and 5.5% state sales tax.
Wisconsin Riverside Resort, 513220 Shifflet Rd, Spring Green WI 53588
608-588-2826 or events@wiriverside.com
Photography Credit-Copper Antler Photography & S. Cole Photography

Revised 11.13.18

Chilled Appetizers

BRUSCHETTA

Roma tomatoes mixed with fresh basil and balsamic reduction and your choice of toasted croissants or tortilla chips \$70

COCKTAIL SHRIMP (50 ea.)

Jumbo shrimp served with a homemade cocktail sauce \$135

CHEESE, SAUSAGE & CRACKER PLATTER

An assortment of local Wisconsin cheese and sausage \$75

DEVILED EGGS (50 ea.)

Traditional Style \$50

PINWHEELS

Ham, lettuce, tomato & cheddar cheese
OR
Turkey, lettuce, tomato & swiss cheese \$75

FRESH FRUIT PLATTER

Seasonal Fruits \$90

TACO DIP PLATTER

Sour cream and salsa topped with taco meat, lettuce, tomatoes, black olives and cheddar cheese. Served with tortilla chips. \$60

FRESH VEGETABLE PLATTER

Served with your choice of onion dip or ranch dressing \$90

PETITE SANDWICHES (50 ea.)

Thinly sliced meat served on a mini croissant
Oven Roasted Turkey \$120
Honey Glazed Ham \$110
Italian Marinated Beef \$125

SMOKED SALMON

Served with veggies & sauce \$Market

Serves 50

If you want something that is not listed, feel free to call us and we'll be happy to work with you.
Prices are subject to change. Prices do not include 18% service charge and 5.5% state sales tax.

Wisconsin Riverside Resort, 513220 Shifflet Rd, Spring Green WI 53588

608-588-2826 or events@wiriverside.com

Photography Credit-Copper Antler Photography & S. Cole Photography

Revised 11.13.18

Hot Appetizers

STUFFED MUSHROOMS

Mushroom caps stuffed with your choice of garlic herb vegetable or a shrimp compote \$70

SPINACH & ARTICHOKE DIP

A creamy jalapeno spinach artichoke dip served with toasted bread or tortilla chips \$70

CRAB CAKES

Mini crab cakes served with a lemon and caper remoulade \$135

SPANAKOPITA

Spinach & cream cheese wrapped in filo dough \$70

CHICKEN OR BEEF SKEWERS

Served with your choice of sauce \$90

MACARONI & CHEESE

Homemade deliciousness \$55

RUMAKI

Bacon wrapped water chestnuts \$85

CHICKEN WINGS

Fresh wings served naked, mild, hot, BBQ or Teriyaki Sauce \$55

MEATBALLS

Oven roasted meatballs with your choice of plain, BBQ, teriyaki or mushroom cream sauce \$65

COCKTAIL FRANKS

Mini cocktail franks served in a homemade BBQ sauce \$45

POTATO SKINS

A roasted potato skin stuffed with cheese & bacon topped with chives and a side of sour cream \$75

CHICKEN STRIPS

Served with your choice of sauce \$75

BBQ PORK RIBLET

Served with our homemade BBQ sauce \$100

Serves 50

If you want something that is not listed, feel free to call us and we'll be happy to work with you. Prices are subject to change. Prices do not include 18% service charge and 5.5% state sales tax.

Wisconsin Riverside Resort, 513220 Shifflet Rd, Spring Green WI 53588

608-588-2826 or events@wiriverside.com

Photography Credit-Copper Antler Photography & S. Cole Photography

Revised 11.13.18

Breakfast

Mini Continental

\$6 per
person

- ◇ Chilled Orange Juice
- ◇ Assorted Pastries & Muffin
- ◇ Coffee (regular & decaffeinated)

Riverside Continental

\$8.50 per
person

- ◇ Chilled Orange Juice
- ◇ Assorted Pastries & Muffins
- ◇ Assorted Bagel & Cream Cheese
- ◇ Fresh Fruit Display
- ◇ Coffee (regular & decaffeinated)

Breakfast Buffet

\$12 per
person

- ◇ Chilled Orange Juice
- ◇ Assorted Pastries & Muffins
- ◇ Scrambled Eggs
- ◇ Fried Potatoes
- ◇ Bacon
- ◇ Sausage
- ◇ French Toast & Syrup
- ◇ Biscuits & Gravy
- ◇ Fresh Fruit Display
- ◇ Coffee (regular & decaffeinated)

Breakfast Beverages

COFFEE STATION
\$12 Per Container

CHILLED ORANGE JUICE
\$5 Per Pitcher

If you want something that is not listed, feel free to call us and we'll be happy to work with you.
Prices are subject to change. Prices do not include 18% service charge and 5.5% state sales tax.

Wisconsin Riverside Resort, 513220 Shifflet Rd, Spring Green WI 53588

608-588-2826 or events@wiriverside.com

Photography Credit-Copper Antler Photography & S. Cole Photography

Revised 11.13.18

Meetings, Luncheons & Other

Sandwiches

Served with two sides. Add \$1.00 per person for a garden tossed salad

OPEN FACED GRILLED CHICKEN SANDWICH

Served with Mashed Potatoes & Gravy \$9.75

HOT TURKEY SANDWICH

Hot shredded turkey served on a bun \$9.50

HOT BEEF SANDWICH

Seasoned beef shredded and served on a bun \$9.50

BARBEQUE PULLED PORK SANDWICH

Pulled pork smothered in barbeque sauce \$9.50

HOT HAMBURGER SANDWICH

Hamburger patty served over a slice of bread and mashed potatoes covered in gravy \$9.75

SLOPPY JOE

Ground beef with a tomato sauce served on a bun \$9.50

COLD TURKEY OR HAM SANDWICH

Ham or turkey topped with lettuce, cheese and tomato. Butter, mustard and mayo on the side \$8.50

Italian Buffet

Served with a garden salad and garlic bread

LASAGNA \$12.95

Meat or Veggie Lasagna

PIZZA BUFFET \$10.95

CHICKEN FETTUCCINI ALFREDO \$14.95

SPAGHETTI & MEATBALLS \$12.95

Riverside Lunch Options

BUILD YOUR OWN TACO BAR

Chicken or Beef. Taco toppings include: cheese, onions, tomatoes, black olives, jalapenos, refried beans, lettuce, salsa and sour cream. \$11.95

CAMP-OUT BUFFET

Burgers and brats, potato salad, baked beans, corn and coleslaw. Add cheese for .35 per person \$11.95

MEATLOAF

Served with Mashed Potatoes & Gravy and Corn or Green Beans \$9.75

CHICKEN POT PIE

Served over Biscuits \$9.50

CAESAR SALAD \$8.00 per person

Add Chicken for \$2.00 per person

CHEF'S SALAD \$9.95 per person

SOUP OR CHILI

CUP \$2.50 per person

BOWL \$3.50 per person

Light Lunch Sides

POTATO SALAD

GREEN BEANS

POTATO CHIPS

CHEESY POTATOES

PASTA SALAD

CORN

BAKED BEANS

COLESLAW

If you want something that is not listed, feel free to call us and we'll be happy to work with you. Prices are subject to change. Prices do not include 18% service charge and 5.5% state sales tax.

Wisconsin Riverside Resort, 513220 Shifflet Rd, Spring Green WI 53588

608-588-2826 or events@wiriverside.com

Photography Credit-Copper Antler Photography & S. Cole Photography

Revised 11.13.18

Traditional Buffet

2 Entrees, tossed garden salad, 2 sides, roll & premium coffee

\$21.95

CHEESE TORTELLINI

Cheese stuffed tortellini served with alfredo or marinara sauce

CHICKEN PICCATA

Seasoned chicken breast sautéed in a lemon caper white wine sauce

CHICKEN MARSALA

Baked chicken breast laced in a Marsala wine sauce

CHICKEN BREAST

A grilled chicken breast served with your choice of Cacciatore, Roasted Gravy or Mushroom Cream Sauce

BAKED CHICKEN BONE-IN

Made with a lemon, cilantro & garlic marinade

BAKED HAM

A honey glazed ham

ROASTED TURKEY

Roasted all white meat turkey breast

LASAGNA

Beef or vegetable with homemade marinara

STROGANOFF

Beef or vegetables served with homemade mushroom sauce served over rice, noodles or potatoes

BEEF POT ROAST

Tender slow roasted beef smothered in gravy

Enhanced Buffet

2 Entrees from Enhanced or Traditional, tossed garden salad, 2 sides, roll & premium coffee

\$23.95

CHICKEN CORDON BLEU

Breaded baked chicken breast stuffed with ham and swiss cheese and topped with a cream sauce

PORK TENDERLOIN

Herb incrusted pork loin served with a mushroom cream sauce or a cheese béchamel sauce

CHICKEN PARMESAN

Chicken breast over fettuccini covered in homemade marinara sauce and mozzarella

Premium Buffet

1 Entree from Premium and 1 Entree from Enhanced or Traditional, tossed garden salad, 2 sides, roll & premium coffee

\$24.95

BAKED SALMON

Salmon filet served natural or topped with a honey Dijon mustard glaze

BAKED COD

Baked North Atlantic cod

BAKED TILAPIA

Italian herb encrusted

PRIME RIB (\$1.00 per plate)

Served with au jus

If you want something that is not listed, feel free to call us and we'll be happy to work with you. Prices are subject to change. Prices do not include 18% service charge and 5.5% state sales tax.

Wisconsin Riverside Resort, 513220 Shifflet Rd, Spring Green WI 53588

608-588-2826 or events@wiriverside.com

Photography Credit-Copper Antler Photography & S. Cole Photography

Revised 11.13.18

Side Dishes

BAKED POTATO

Served with butter & sour cream

MASHED POTATOES WITH GRAVY

Yukon Gold

GARLIC MASHED REDSKINS

Roasted garlic mixed with baby red potatoes

SCALLOPED POTATOES

Sliced potatoes with a butter sauce

AU GRATIN

Sliced potatoes with mushroom and cheese sauce

PARSLEY BOILED NEW POTATOES

RICE PILAF

WILD RICE

BAKED BEANS

STEAMED VEGETABLES

Carrots, broccoli & cauliflower

GREEN BEANS ALMONDINE

Sautéed green beans topped with roasted almonds and bacon

HONEY GLAZED BABY CARROTS

COLESLAW

POTATO SALAD

BRUSSEL SPROUTS

Sautéed with bacon

ITALIAN PASTA SALAD

MACARONI & CHEESE

Homemade deliciousness

Desserts

MINI CHEESECAKES

Assorted mini cheesecakes (50 mini cheesecakes) \$90

ASSORTED CHEESECAKE

Delicious cheesecake priced per slice \$4.25

FUDGE CAKE

Moist fudge cake with rich chocolate fudge icing and chocolate crunch on the sides.

Priced per slice \$3.95

COOKIES

A dozen assorted cookies \$15

CARROT CAKE BARS

Carrot cake topped with cream cheese frosting (80 bars) \$65

SCOTCHEROOS

Crispy peanut butter bars topped with chocolate (80 bars) \$60

BROWNIES

Iced fudge brownies with nuts (20 brownies) \$35

If you want something that is not listed, feel free to call us and we'll be happy to work with you.
Prices are subject to change. Prices do not include 18% service charge and 5.5% state sales tax.

Wisconsin Riverside Resort, 513220 Shifflet Rd, Spring Green WI 53588

608-588-2826 or events@wiriverside.com

Photography Credit-Copper Antler Photography & S. Cole Photography

Revised 11.13.18

River Room Bar Information

NON-ALCOHOLIC

COFFEE

\$15 per container

ICED TEA

\$4 per pitcher

CANNED SODA

\$1.25 per can

SODA

Pepsi products. \$4 per pitcher

LEMONADE

\$30 per container

FRUIT PUNCH

\$30 per container

BOTTLED WATER

\$1 per bottle

MILK

\$5 per pitcher

HOUSE WINE & SPARKLING WINE

WHITE WINES

ANTHONY'S HILL FETZER CHARDONNAY

\$20 (1.5L) per bottle/ \$120 per case

Ca'DONINI PINOT GRIGIO

\$20 per bottle/ \$240 per case

HEINZ EIFEL SHINE RIESLING

\$18 per bottle/ \$216 per case

WOLLERSHEIM PRAIRIE FUME

\$20 per bottle/ \$240 per case

BAREFOOT MOSCATO

\$12 per bottle/ \$144 per case

BLUSH WINES

FÜNF SANGRIA

\$12 per bottle/ \$144 per case

WOODBRIDGE WHITE ZINFANDEL

\$12 per bottle/ \$144 per case

RED WINES

ANTHONY'S HILL FETZER DARK BOLD RED

\$20 (1.5L) per bottle/ \$120 per case

WILLIAM HILL CABERNET SAUVIGNON

\$22 per bottle/ \$264 per case

RED ROCK MERLOT

\$20 per bottle/ \$240 per case

GREG NORMAN PINOT NOIR

\$29 per bottle/ \$348 per case

MÉNAGE à TROIS

\$20 per bottle/ \$240 per case

SPARKLING WINES

WYCLIFF BRUT CHAMPAGNE

\$12 per bottle/ \$144 per case

BEER

DOMESTIC BEER

Busch Light, Miller Light, Bud Light, Budweiser, Leinenkugel's etc. \$250

PREMIUM BEER

New Glarus Spotted Cow \$350

Lake Louie Pale Ale, Warped Speed etc. See Event Coordinator for pricing

Other Beer, Wine, Champagne and Liquors are available upon request.

If you want something that is not listed, feel free to call us and we'll be happy to work with you.
Prices are subject to change. Prices do not include 18% service charge and 5.5% state sales tax.

Wisconsin Riverside Resort, 513220 Shifflet Rd, Spring Green WI 53588

608-588-2826 or events@wiriverside.com

Photography Credit-Copper Antler Photography & S. Cole Photography

Revised 11.13.18

River Room Layout

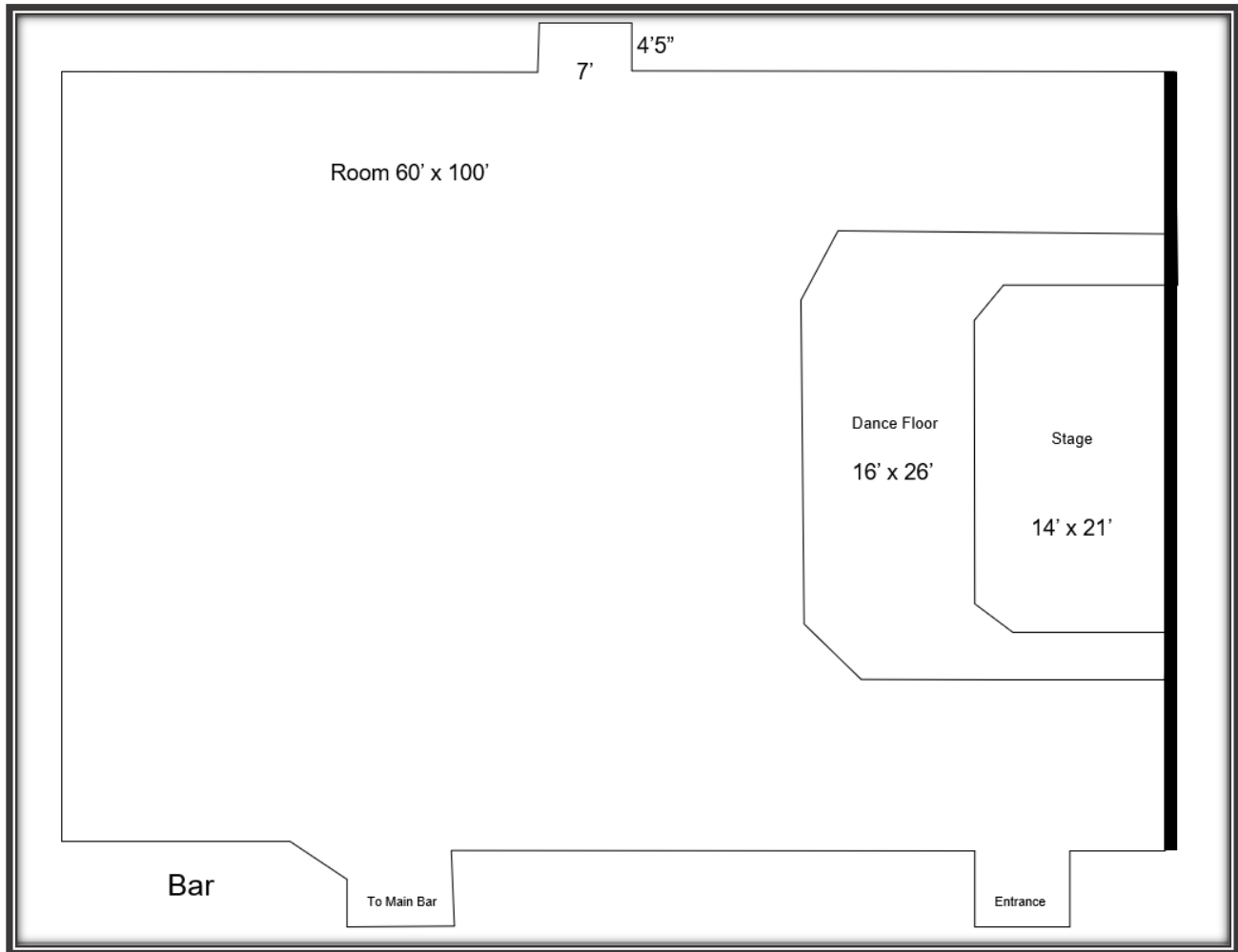

If you want something that is not listed, feel free to call us and we'll be happy to work with you.
Prices are subject to change. Prices do not include 18% service charge and 5.5% state sales tax.
Wisconsin Riverside Resort, 513220 Shifflet Rd, Spring Green WI 53588
608-588-2826 or events@wiriverside.com
Photography Credit-Copper Antler Photography & S. Cole Photography

Revised 11.13.18

Wisconsin Riverside Resort---The River Room Facility Contract

Wisconsin Riverside Resort appreciates the opportunity to host your group/function on the date listed below. You can rest assured we will do our utmost to guarantee a successful event.

Client Information

Name of Client(s):

Cell Phone: Home/Work Phone:

Address:

Street City State Zip Code

E-mail Address:

Event Details

Function Type: Date of Function:

Time of Function: Number of Guests:

Type of Meal:

Entertainment:

Comments/Special Requests:

I have read and agree to the information, policies, fees, terms and conditions of this contract and I am authorized to sign this agreement for the client above.

Signed and agreed upon by:

Signature (Client)

Date

Accepted by: Wisconsin Riverside Resort, Inc.

Signature (Event Coordinator)

Date

If you want something that is not listed, feel free to call us and we'll be happy to work with you.
Prices are subject to change. Prices do not include 18% service charge and 5.5% state sales tax.
Wisconsin Riverside Resort, 513220 Shifflet Rd, Spring Green WI 53588
608-588-2826 or events@wiriverside.com
Photography Credit-Copper Antler Photography & S. Cole Photography

Revised 11.13.18

Wisconsin Riverside Resort

LOCATION: Wisconsin Riverside Resort is located on the banks of the Lower Wisconsin River, just 35 miles west of Madison.

CAMPGROUND: Wisconsin Riverside Resort has 2 cabins, 95 overnight full hook-up RV sites (water, sewer & electric), 22 rustic tent sites, swimming pool and splash pad, camp store, volleyball, basketball, shuffleboard, mini golf, fishing and more.

CANOE, TUBE & KAYAK RENTALS: Spend a leisurely day on the Wisconsin River. Wisconsin Riverside Resort offers canoe, tube or kayak rentals with shuttle service. Camp on a sandbar! Check-in at our facility, we shuttle you up-river, and float right back to Wisconsin Riverside Resort. Trips last from ½ hour to 4 days.

SHIFFLET'S BAR & GRILLE: Built in 2010 and located on the banks of the Wisconsin River, Shifflet's Bar & Grille will meet all your dining and socializing needs.....and we have a great view too! Join us on our patio for a nice cool brew while watching the river go by.

THE RIVER ROOM: The River Room is a 400 person banquet facility built in 2011 as an extension to the current bar & grille. Perfect for any occasion: weddings, anniversary parties, class reunions, company events, holiday parties etc.

LIZA'S LAGOON: A 1 acre man-made pond with inflatable sports park. Open Memorial Day – Labor Day.



S13220 Shifflet Road, Spring Green WI 53588

•Phone: 608-588-2826 • Fax: 608-588-3476 • www.wiriverside.com • events@wiriverside.com•

If you want something that is not listed, feel free to call us and we'll be happy to work with you.
Prices are subject to change. Prices do not include 18% service charge and 5.5% state sales tax.

Wisconsin Riverside Resort, S13220 Shifflet Rd, Spring Green WI 53588

608-588-2826 or events@wiriverside.com

Photography Credit-Copper Antler Photography & S. Cole Photography

Revised 11.13.18

We Recommend

ENTERTAINMENT:

Midnight Diva's Karaoke & DJ Service, Arena WI, 608-588-5477, www.midnightdivas.net
Edge DJ Entertainment, 6217 Harvest Ln, Deforest WI 53532, 608-318-3548, www.edgeDJ.com
Dance Doctors, Richland Center WI, 608-604-2841
It's Your Party, 6343 Nesbitt Madison WI, 608-845-3450

HOTELS/MOTELS:

Spring Green Motel, E5296B Hwy 14, Spring Green WI 53588, 608-588-2141
The Round Barn Lodge, Hwy 14, Spring Green WI 53588, 608-588-2568
Spring Valley Inn, Hwy 14, Spring Green WI 53588, 608-588-7828
The House on the Rock Resort, 400 Springs Drive, Spring Green WI 53588, 608-588-7000

GOLF:

House on the Rock Resort, Springs Drive, Spring Green WI 53588 608-588-7000
Spring Green Municipal Golf Course Hwy 23, Spring Green WI 53588
Westbrook Hills, Hwy 23, Plain WI 53577, 608-546-4001

AREA ATTRACTIONS:

Taliesin, www.taliesinpreservation.org, 608-588-7900
The House on the Rock, www.thehouseontherock.com, 608-935-3639
American Players Theatre, www.americanplayers.org, 608-588-2631

If you want something that is not listed, feel free to call us and we'll be happy to work with you.
Prices are subject to change. Prices do not include 18% service charge and 5.5% state sales tax.
Wisconsin Riverside Resort, 513220 Shifflet Rd, Spring Green WI 53588
608-588-2826 or events@wiriverside.com
Photography Credit-Copper Antler Photography & S. Cole Photography

Revised 11.13.18